

U.S. DEPARTMENT OF COMMERCE  
 ENVIRONMENTAL SCIENCE SERVICES ADMINISTRATION  
 COAST AND GEODETIC SURVEY  
 WASHINGTON, D.C.

**TRIANGULATION DIAGRAM  
 STATE OF MICHIGAN  
 (SOUTHERN SECTION)**

November 1969

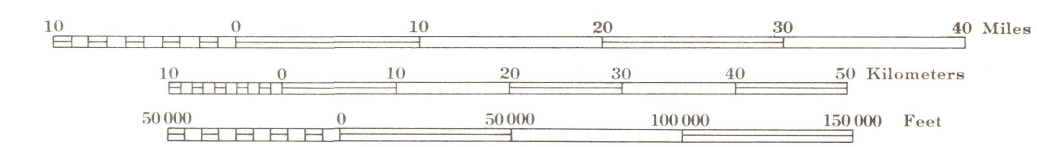

Information may be obtained from the Coast and Geodetic Survey, Environmental Science Services Administration, Rockville, Maryland 20852.

Each 30 minute quadrangle (shown in blue) is identified in the southeast corner by a six digit number showing successively degrees of latitude, degrees of longitude, and position in its one degree quadrangle.

Note: Data may be requested by quadrangle, county, or other unit. Since publication of data in quadrangle units may not be complete for this State, requests for information by quadrangle number will be supplied with data in whatever form is available.

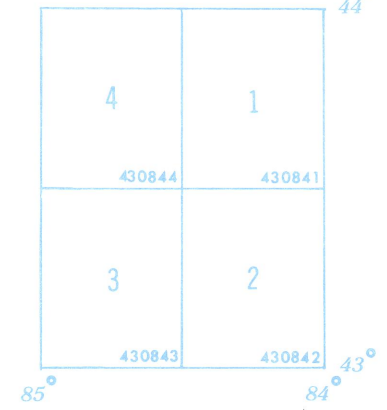

**HORIZONTAL CONTROL**

- Monumented Point or Located Object
- Non-monumented Point (for names of numbered stations)
- Station (referred to as unnumbered)
- Measured Base - Electronic or Taped
- Line of triangulation observed
- Line of triangulation observed (horizontal only)
- Measured Length - Electronic

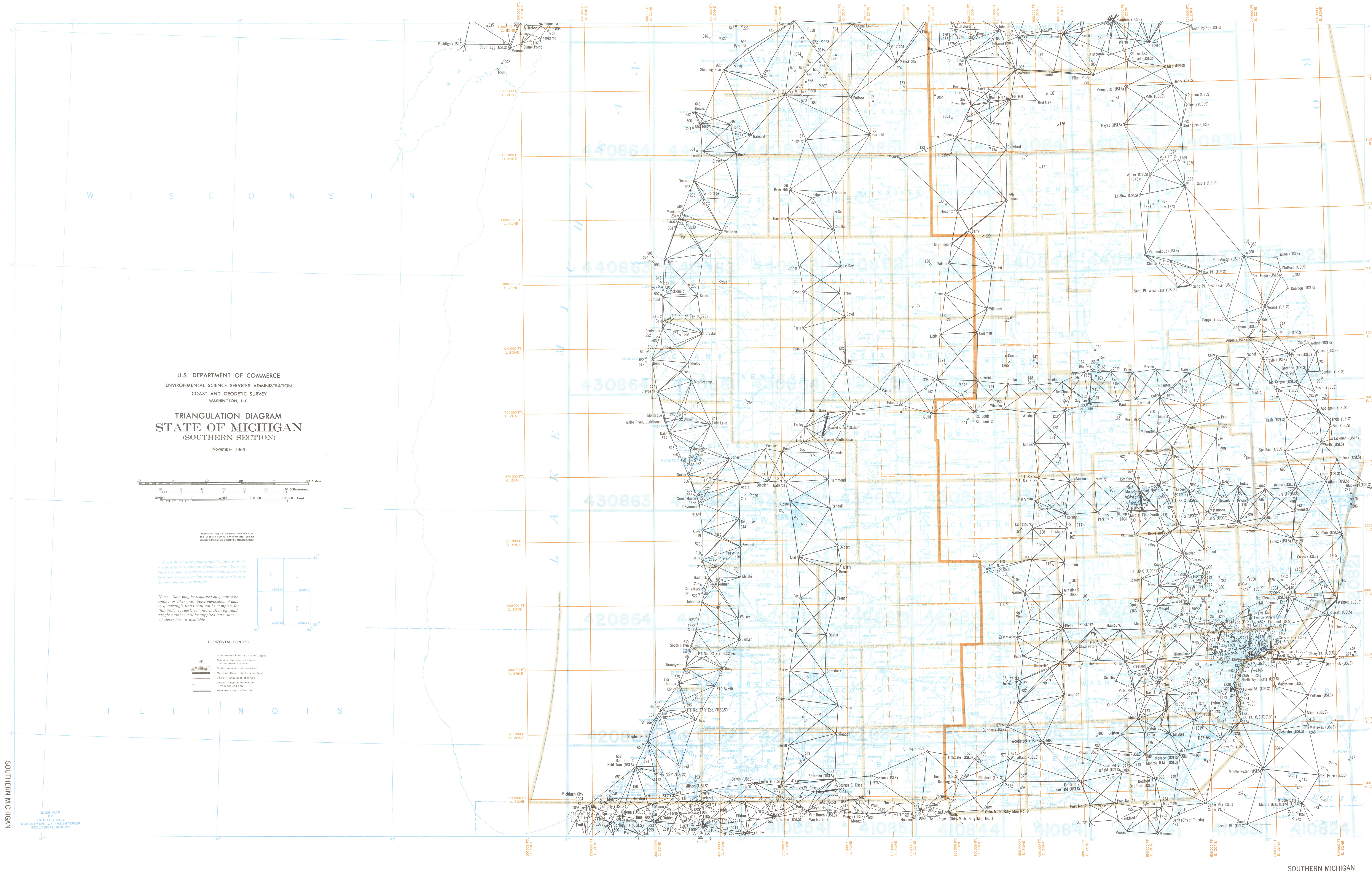

SOUTHERN MICHIGAN

SOUTHERN MICHIGAN