

Additional triangulation in vicinity of Houston will be found on Geodetic Control Diagrams HOUSTON NH 15-7 and BEAUMONT NH 15-4.

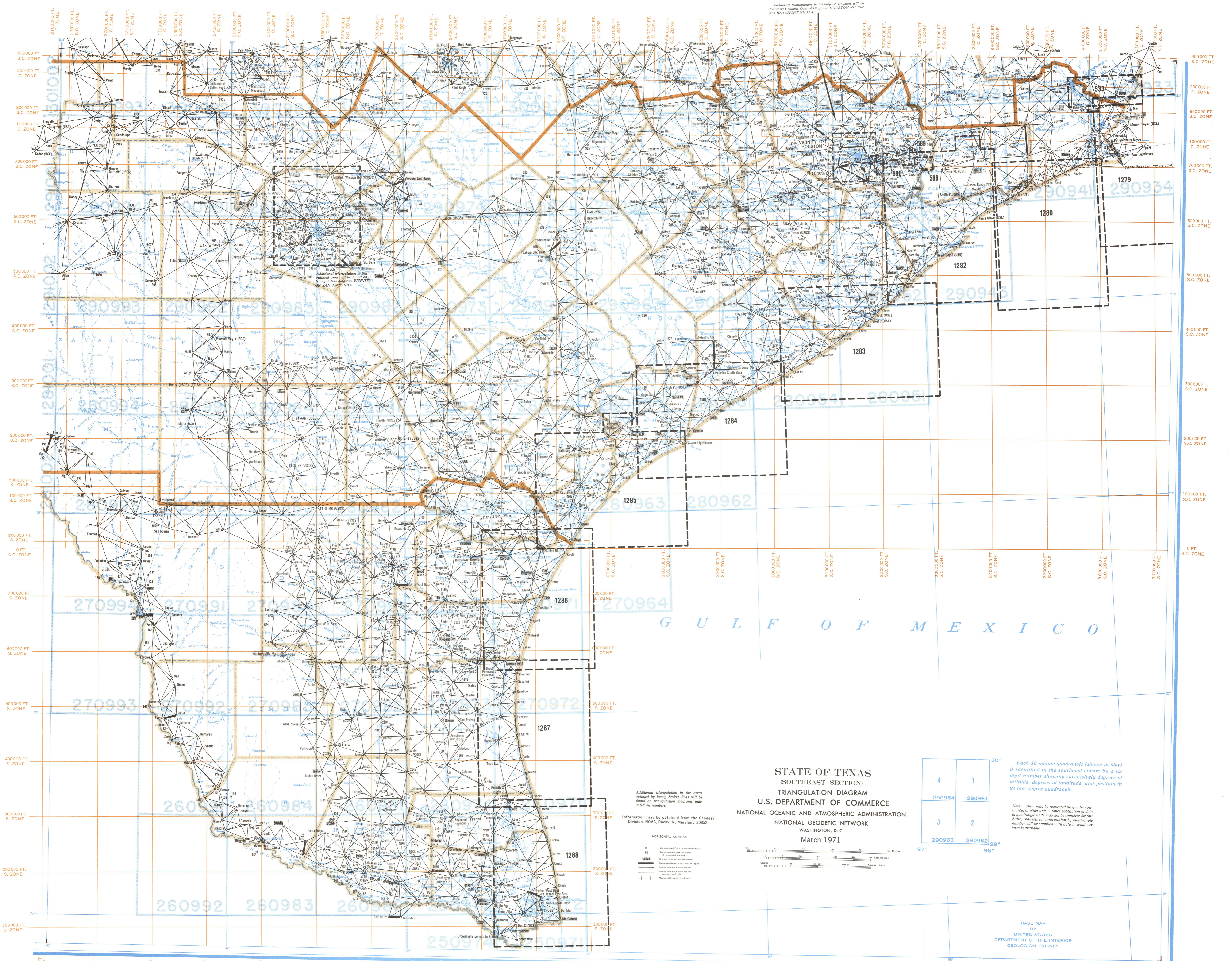

S.E. TEXAS

Information may be obtained from the Geodesy Division, NOAA, Rockville, Maryland 20852.

HORIZONTAL CONTROL

- 60' Monument Point or Labeled Object
- See separate sheet for names of monument points
- Station not monumented
- Monumented station or point
- Line of triangulation observed
- Line of triangulation computed
- Monument length indicated

STATE OF TEXAS  
(SOUTHEAST SECTION)  
TRIANGULATION DIAGRAM  
U.S. DEPARTMENT OF COMMERCE  
NATIONAL OCEANIC AND ATMOSPHERIC ADMINISTRATION  
NATIONAL GEODETIC NETWORK  
WASHINGTON, D. C.  
March 1971

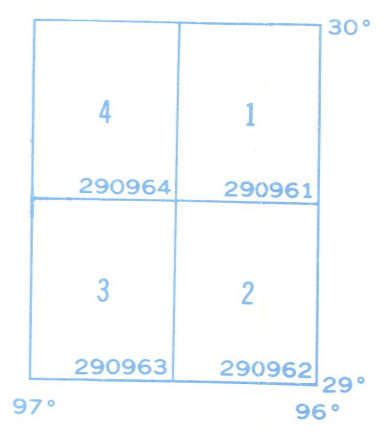

Each 30 minute quadrangle (shown in blue) is identified in the southeast corner by a six digit number showing successively degrees of latitude, degrees of longitude, and position in its one degree quadrangle.

Note: Data may be requested by quadrangle, county, or other unit. Since publication of data in quadrangle units may not be complete for this State, requests for information by quadrangle number will be supplied with data in whatever form is available.

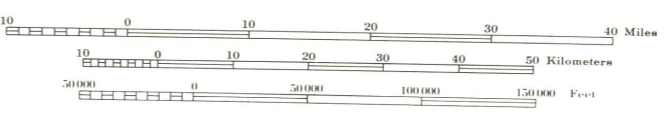

BASE MAP BY UNITED STATES GEOLOGICAL SURVEY